



Santa Croce Florence Monumental Complex

Monumental tombs and memorials

- 1 *Leonardo Bruni* by Bernardo Rossellino, 1445-47
- 2 *Carlo Marsuppini* by Desiderio di Settignano, 1453-55
- 3 *Michelangelo Buonarroti* by Giorgio Vasari, 1564-78
- 4 *Galileo Galilei* by Giulio Foggini, 1734-37
- 5 *Niccolò Machiavelli* by Innocenzo Spinazzi, 1787
- 6 *Vittorio Alfieri* by Antonio Canova, 1804-10
- 7 *Dante Alighieri* by Stefano Ricci, 1819-30
- 8 *Leon Battista Alberti* by Lorenzo Bartolini, 1838-50
- 9 *Charlotte Bonaparte* by Lorenzo Bartolini, 1840
- 10 *Statue of Liberty* by Pio Fedi, 1870-76
- 11 *Gioachino Rossini* by Giuseppe Cassioli, 1900-02
- 12 *Ugo Foscolo* by Antonio Berti, 1939
- 13 *Florence Nightingale* by Francis William Sargent, 1913
- 14 Chapel of the Italian Mother by Libero Andreotti, 1926

Painting

- 15 Coppo di Marcovaldo, *Bardi Altarpiece*, 1245-50
- 16 Cimabue, *Crucifix*, before 1288
- 17 Giotto, *Stories of St. John the Baptist and St. John the Evangelist*, 1317-20
- 18 Giotto, *Stories of St. Francis*, 1320-25
- 19 Giotto, *Baroncelli Polyptych*, 1328-30
- 20 Taddeo Gaddi, *Stories of the Virgin Mary*, 1328-30
- 21 Taddeo Gaddi, Spinello Aretino, Niccolò di Pietro Gerini, *Stories of Christ*, 1340-1410
- 22 Andrea Orcagna, *Triumph of Death, Last Judgement, Hell*, c. 1350
- 23 Taddeo Gaddi, *Tree of Life and Last Supper*, c. 1350
- 24 Giovanni da Milano and Matteo di Pacino, *Stories of the Virgin Mary and St. Mary Magdalene*, 1359-71
- 25 Agnolo Gaddi, *Legend of the True Cross*, 1380-90
- 26 Giorgio Vasari, *Last Supper*, 1546
- 27 Bronzino, *Descent of Christ into Limbo*, 1552
- 28 Bronzino, *Pieta*, 1569

Sculpture

- 29 Donatello, *Crucifix*, 1408
- 30 Donatello, *St. Louis of Toulouse*, 1422-25
- 31 Donatello, *Annunciation*, 1433-35
- 32 Antonio Rossellino, *Virgin of Milk*, after 1478
- 33 Benedetto da Maiano, *Pulpit*, 1481-87
- 34 Baccio Bandinelli, *God the Father*, 1552
- 35 Henry Moore, *Warrior with Shield*, 1972

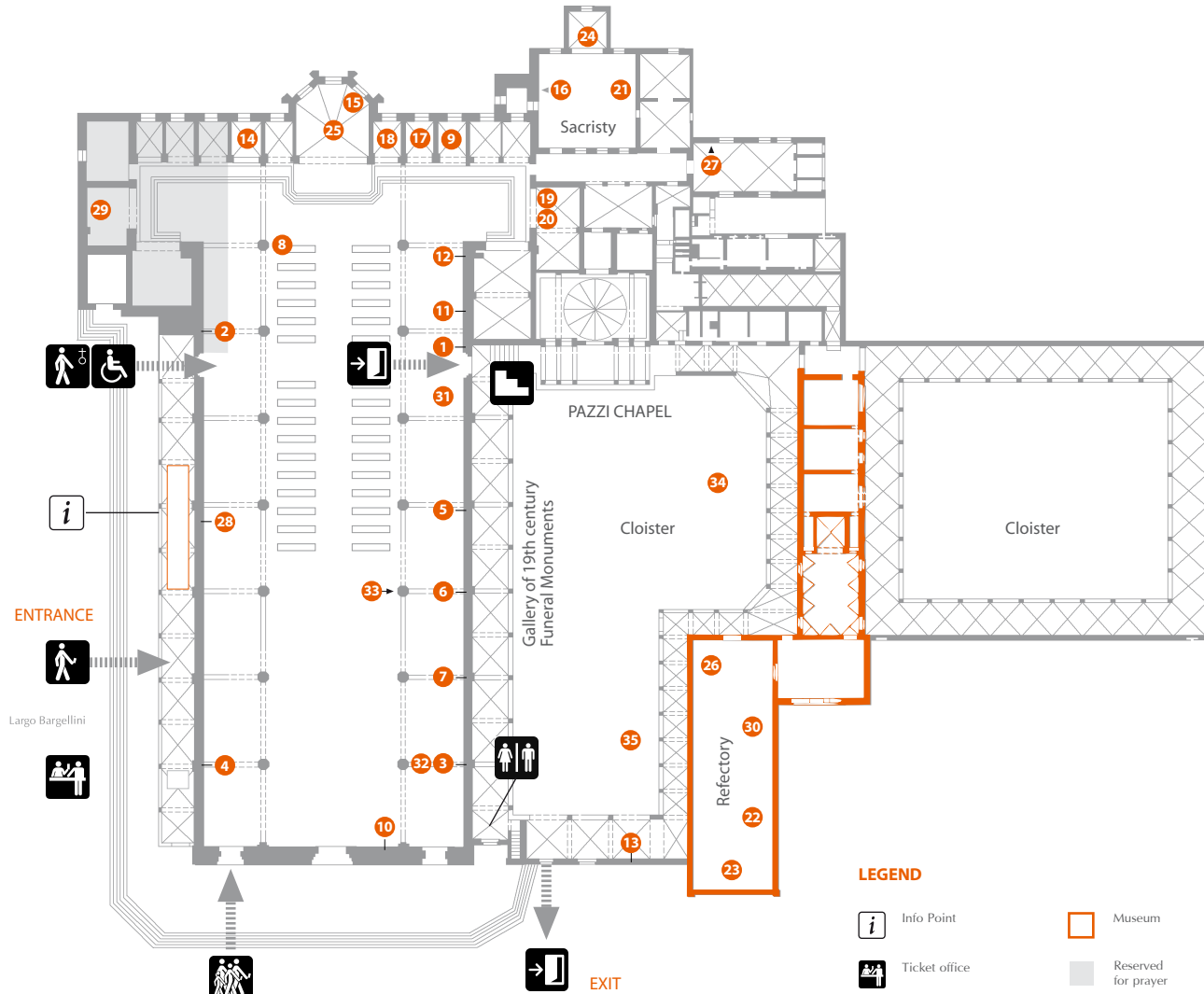

Santa Croce Square

LEGEND

- | | | | |
|--|--------------------------|--|---------------------|
| | Info Point | | Museum |
| | Ticket office | | Reserved for prayer |
| | Entrance for visitors | | Stairs |
| | Entrance for worshippers | | Toilet |
| | Entrance for groups | | Exit |
| | Entrance for disabled | | |

THE CHURCH OF SANTA CROCE

The Franciscan Basilica of Santa Croce, began in 1295, contains over seven centuries of Florentine and Italian history.

Within the walls of the impressive Gothic structure and its adjoining monumental spaces, are preserved the works of artists such as Cimabue, Giotto, Donatello, Brunelleschi, Della Robbia, Vasari, Bronzino and Canova. Santa Croce, also known as the Pantheon of Italian Greats, preserves the memory and monuments of illustrious men, including Michelangelo, Galileo, Machiavelli, Alfieri, Foscolo and Rossini.

Opera di Santa Croce is a nonprofit organization that has been in charge of the church and monumental complex upkeep since the 14th century. It does not receive any State funding and for its activities it relies on donations by private individuals or corporations, and on the proceeds of admission tickets.

Opening Times

Monday - Saturday: 9.30am - 5.30pm
Sundays and religious holidays: 2pm - 5.30pm
Epiphany; Assumption; All Saints Day; Immaculate Conception

The ticket office closes at 5pm

The ticket gives access to the entire monumental complex

Closing days

New Year's Day; Easter; St. Anthony's Day; St. Francis; Christmas; St. Stephen's Day

For informations:

www.santacroceopera.it
segreteria@santacroceopera.it
Tel + 0039 055 2466105

For Religious Services:

Tel + 0039 055 244619
f.andreaforini@gmail.com

Santa Croce is first of all a sacred place, you are kindly invited to respect it with silence and a proper behavior